

# SAFETY CHAIR

Experts in safe evacuation

Experts in  
safe evacuation





# SAFETY CHAIR

Experts in safe evacuation

## We offer the perfect solution for stairway evacuation

Safety Chair are solely dedicated to effective evacuation. Our trusted specialists who have many years of experience, ensure you receive guidance on your evacuation requirements.

What makes us different is when it comes to price, quality, reliability, flexibility, satisfaction, compliance and information, we simply won't be beaten.



As leaders in Safe Evacuation, we have a rich history of delivering both exceptional service and unrivalled products.

Our **Price Promise** also gives you the peace of mind that you are receiving the best value possible. We are committed to supporting the life of the products we supply and ensuring quality is never compromised. Our tailored approach gives you a great opportunity to see our products in a real-world setting, paired with our Evacuation Site Survey you will be left knowing the best solutions for your situation.

From on-site demonstrations to dealing with a question over the phone we are committed delivering 100% satisfaction to all of customers.

# EV4000

## The standard model evacuation chair

Provides a quick, easy and safe emergency evacuation with a 200kg (440lbs) weight capacity and allows for single person operation.



### FEATURES

- 1. Adjustable self braking tracks**  
Reinforced adjustable tracks control the speed of descent
- 2. Anti-slip height adjustable handle**  
For ease of deployment, operation and compact storage
- 3. Head support with immobilisation strap**  
Limits movement, securing the passenger
- 4. Quick release 4-point harness**  
4 point harness for increased passenger welfare
- 5. Heavy duty front wheels**  
For smoother operation over rugged terrain
- 6. Industrial locking castor wheels**  
For situations where the chair needs to be stationary
- 7. Way finding decals**  
For easy location in emergency situations
- 8. Adjustable seating position**  
Allows for the ideal passenger seating position, either flat seat or hammock

### DIMENSIONS

Height	Width	Depth	Weight	Weight Capacity
124cms 48"	57cms 22.5"	26.5cms 10.5"	14.3kgs 31.5lbs	200kgs 440lbs

### BENEFITS

- Single person operation up to 200kg (441lbs)
- Easy to open, ready to operate in seconds
- Provides a rapid solution for safe emergency evacuation
- Simple to operate
- Lightweight construction
- Minimal moving and handling required
- Allows small operators to transport passengers larger than their size
- Foldable for easy storage
- Fire retardant material
- Wall mountable
- Low maintenance

### INCLUDES

- LIFETIME WARRANTY
- 4 Point Passenger Harness
- Cushioned Head Support
- Adjustable Padded Seat
- Way Finding Signage
- Wall Mounting Hooks
- Protective Cover
- User Guide
- FREE UK Delivery

# EV5000

## Robust, versatile with quick deployment

The EV-5000 is capable of various forms of evacuation. Suitable for 1 or 2 person operation, our Safety-Trac belts give the user ultimate control for both ascending and descending evacuation.

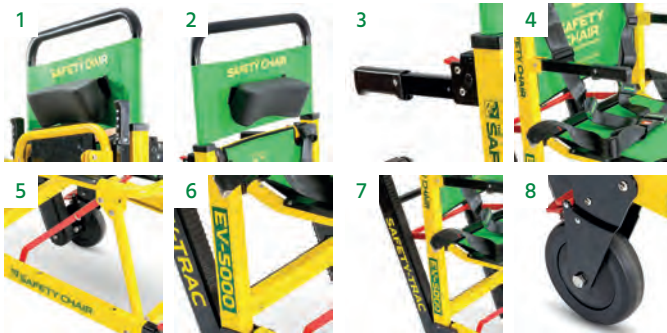

### FEATURES

- 1. Head support with padded cushion**  
Headrest with padded cushion for comfortably securing the passenger in place
- 2. Anti-slip height adjustable handle**  
For ease of deployment, operation and compact storage
- 3. Additional operator handles**  
For added stability when employing additional operators
- 4. Quick release 4-point harness**  
4 point harness for increased passenger welfare
- 5. High strength aluminium frame**  
Increased strength and robustness for continued use
- 6. Way finding decals**  
For easy location in emergency situations
- 7. Adjustable self braking tracks**  
Reinforced adjustable tracks control speed of descent on all types of stairways
- 8. Industrial locking rear wheels**  
For application in situations where the chair needs stay in a stationary position

### DIMENSIONS

Height	Width	Depth	Weight	Weight Capacity
110cms 43.3"	57cms 22.4"	26.5cms 10.4"	21kgs 41lbs	158kgs 350lbs

### BENEFITS

- Simple to operate
- Single person operation in descent
- Easy to open, ready to operate in seconds
- Robust and compact in size
- Lightweight construction
- Provides a rapid solution for safe emergency evacuation
- Minimal moving and handling required
- Allows small operators to transport passengers larger than their size
- Foldable for easy storage
- Wall mountable
- Low maintenance

### INCLUDES

- 4 Point Passenger Harness
- Cushioned Head Support
- Way Finding Signage
- Wall Mounting Hooks
- Protective Cover
- User Guide
- FREE UK Delivery

# EV7000

## Higher weight capacity of 250kg (550lbs) for bariatric passengers

Assists with downward evacuation for bariatric payloads in an emergency evacuation. This evacuation chair can also be used for upward and downward evacuation for non-bariatric payloads.



### FEATURES

- 1. Adjustable self braking tracks**  
Reinforced adjustable tracks control the speed of descent
- 2. Anti-slip height adjustable handle**  
For ease of deployment, operation and compact storage
- 3. Head support with immobilisation strap**  
Limits movement, securing the passenger
- 4. Quick release 4-point harness**  
4 point harness for increased passenger welfare
- 5. Front lifting handle**  
For upstairs travel during 2 and 4 person operation
- 5. Rear lifting handle**  
For upstairs travel during 2 and 4 person operation
- 6. Industrial locking castor wheels**  
For situations where the chair needs to be stationary
- 8. Adjustable seating position**  
Allows for the ideal passenger seating position, either flat seat or hammock

### DIMENSIONS

Height	Width	Depth	Weight	Weight Capacity
124cms 48"	57cms 22.5"	26.5cms 10.5"	14kgs 30.8lbs	250kgs 550lbs

### BENEFITS

- Weight carrying capacity up to 250kg (550lbs)
- Easy to open, ready to operate in seconds
- Simple to operate
- Single person operation up to 200kg (441lbs)
- Lightweight construction
- Provides a rapid solution for safe emergency evacuation
- Minimal moving and handling required
- Allows small operators to transport passengers larger than their size
- Foldable for easy storage
- Fire retardant material
- Wall mountable
- Low maintenance

### INCLUDES

- LIFETIME WARRANTY
- 4 Point Passenger Harness
- Cushioned Head Support
- Adjustable Padded Seat
- Way Finding Signage
- Wall Mounting Hooks
- Protective Cover
- User Guide
- FREE UK Delivery

# EV8000/EV9000

## Powered assistance for upward and downward evacuation

The easier way to evacuate. Our powered solution uses Power-Climb technology to make negotiating stairwells less stressful. Capable of both one and two person operation.

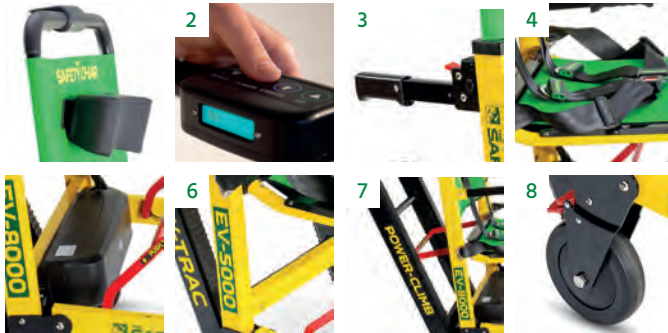

### FEATURES

1. **Anti-slip height adjustable handle**  
For ease of deployment, operation and compact storage
2. **Easy to use control panel**  
With on/off power and ascent and descent buttons
3. **Additional operator handles**  
For added stability when employing additional operators
4. **Quick release 4-point harness**  
4 point harness for increased passenger welfare
5. **Rechargeable lithium ion battery pack**  
Charging time 8 hours (When fully charged is the equivalent to going up and down a 5 storey building flight of stairs 30 times)
6. **High strength aluminium frame**  
Increased strength and robustness for continued use
7. **Adjustable self braking tracks**  
Reinforced adjustable tracks control speed of descent on all types of stairways
8. **Industrial locking rear wheels**  
For application in situations where the chair needs stay in a stationary position

### DIMENSIONS

Height	Width	Depth	Weight	Weight Capacity
116cms 43.3"	57cms 22.4"	32cms 12.6"	33kgs 72.7lbs	EV8000 - 159kgs (350lbs) EV9000 - 227kgs (500lbs)

### BENEFITS

- EV-8000 weight capacity up to 159kg (350lbs)
- EV-9000 weight capacity up to 227kg (500lbs)
- Easy to open, ready to operate in seconds
- Simple to operate
- Single person operation
- Lightweight construction
- Provides a rapid solution for safe emergency evacuation
- Minimal moving and handling required
- Allows small operators to transport passengers larger than their size
- Foldable for easy storage
- Fire retardant material
- Wall mountable • Low maintenance

### INCLUDES

- Battery Charger (UK/EU/US)
- Rechargeable Battery
- 2 Keys
- User Guide
- Passenger Headrest
- 4 Point Passenger Harness
- Way Finding Wall Sign
- Wall Mounting Hooks
- Protective Cover
- Manufacturers Warranty

# EV2000

## A light, portable, strong, high quality stairway carry chair

Provides a quick and easy emergency evacuation with a 159kg (350lbs) weight capacity and folds away neatly for compact storage.



### FEATURES

- 1. Lightweight aluminium body frame**  
Solid aluminium construction ideal for repeated use
- 2. Single movement locking mechanism**  
Chair automatically locks into place when chair is deployed
- 3. Front braking castors**  
For situations where the chair needs to be stationary
- 4. Telescopic passenger arm rests**  
For increased passenger comfort during transportation
- 5. Passenger foot rest**  
For increased passenger comfort during transportation
- 6. Passenger safety belts**  
Limits movement and increases passenger welfare
- 7. Easy clean vinyl seating**  
Simple to clean, resists stains, blood and bodily fluids
- 8. Folds easily**  
For wall mounting or simple storage in areas where space is at a premium

### DIMENSIONS

Height	Width	Depth	Weight	Weight Capacity
109cms 43"	48.8cms 19"	25cms 10"	7.5kgs 16.5lbs	159kgs 350lbs

### BENEFITS

- Weight capacity of 159kg (350lbs)
- Easy to open, ready to operate in seconds
- Provides a rapid solution for safe emergency evacuation
- 4 wheeled for easy horizontal evacuation
- Simple to operate
- Lightweight construction
- Minimal moving and handling required
- Foldable for easy storage
- Fire retardant material
- Wall mountable
- Low maintenance

### INCLUDES

- LIFETIME WARRANTY
- Passenger Safety Belts
- Wall Mounting Hooks
- Protective Cover
- User Guide
- FREE UK Delivery



# Safety Mat

The wall mounted Safety Mat Evacuation Sled from allows the smooth transfer of disable patients over any surface even concrete or stairs. The sled can be stored in the wall mounted bag provided and easily deployed when needed in an emergency. Supplied complete with wall mounted rapid deployment pouch.



## FEATURES

- Dual inner foam provides protection and comfort for patient
- Maximum carrying weight 300kg
- 2 Safety belts and foot pocket to hold the patient safely and securely in place
- Tough slippery coated underside to assist transfer over floor surfaces and stairs
- Complete with storage pouch which can be wall mounted for rapid deployment (fixings not included)
- Manufactured in the UK

## DIMENSIONS

Height	Width	Depth	Weight	Weight Capacity
190cms 75"	60cms 24"	40cms 16"	5.8kgs 12.7lbs	300kgs 660lbs



## BENEFITS

The Safety Mat consists of dual inner foam, lower layer firm to ride over any surfaces, carpets, concrete or any bumps like stairs, and an upper layer for patient comfort. There are safety belts and a foot pocket to hold the patient in place, pulling loops at each end and a tough slippery coated bottom side. The loop at the head end is to hold back when descending stairways. One or two people required.

## NOTES

Due to the lifesaving nature of these devices, it is recommended that a separate evacuation sled is used for drills and training purposes. This will ensure that the sledge used in an emergency has been exposed to minimal wear and tear. In an emergency the folded sled is taken off the wall mount and the patient is transferred from the bed to sled.

# Safety Sheet

The wall mounted Safety Mat Evacuation Sled from allows the smooth transfer of disable patients over any surface even concrete or stairs. The sled can be stored in the wall mounted bag provided and easily deployed when needed in an emergency. Supplied complete with wall mounted rapid deployment pouch.



## FITTING

- Simply lay the Safety Sheet on the base of the bed and place the mattress on the top.
- Concertina the belts and store within the sheets easy to access pockets.
- Attach the Safety Sheet to the mattress using the elastic corner loops.
- Tuck in the end pulling handles at the head and foot end



## FEATURES

- Elastic corner straps for attaching securely to the underside of the mattress
- Pulling handles at each end
- Seat belt style plastic buckles and webbing

## WASHING INSTRUCTIONS

For general cleaning purposes, wipe the cover with warm water containing a neutral detergent. Where disinfection is required following contamination, refer to hospital disinfection policy. Do not use phenolic based cleaners or bleach on this product .If laundering is necessary and disinfection is required wash up to at 70°C. Tumble dry at low temperature. Not iron.

## DIMENSIONS

Packed:	27cm x 10cm x 13cm
Unrolled:	196cm x 85cm
Weight:	1kg
Safety tested to:	250kg
Safe working load:	120kg
Material:	Nylon

# Safety Cot

Designed for the safe evacuation of premature and new born babies from maternity wards and special care baby units in the event of fire or emergency. Portable and lightweight, the Safety Cot enables a single carer to safely evacuate up to two babies (depending on size and condition) while remaining hands free to administer care if needed. Ideal for use in premises where escape routes involve descending stairs.



## FEATURES

- Can carry up to two babies depending on size and condition.
- Enables carers to be 'hands free' to administer needed care to the infant while evacuating.
- Secure storage for a small oxygen cylinder on the underside of the cot to allow manual ventilation of baby if required (Cylinder not included)
- Flexible strong contraction allows for easy handling and adequate support and protection of babies.
- Adjustable shoulder straps.
- Wall mountable for easy, instant access. (fixings not included)

## FITTING

- Remove the Safety Cot from its storage bag and unfold.
- Ensure that the cot is on a flat surface
- Place the straps over the shoulder - creating a single cross over the chest area and fasten using the plastic safety buckles.
- If manual ventilation is needed, a second carer would need to secure the cylinder to the underside of the Safety Cot.
- Move the baby/babies within the Safety Cot, to a safe area.

## BENEFITS

For general cleaning purposes, wipe with warm water containing a neutral detergent. Where disinfection is required following contamination, refer to hospital disinfection policy. Do not use phenolic based cleaners or bleach on this product

## DIMENSIONS

Packed:	62cm x 36cm x 9cm
Opened:	58cm x 30cm x 28cm
Padding:	5mm
Weight:	2kg
Material:	Vinyl

# Operator Training

Our Operator Training course is a 2 hour plus certificated course, which trains your staff on how to correctly use your product in an emergency.

Trainees are given a course manual and reference aids. Upon successfully passing our Operator Training course, applicants are certified in the safe use of their evacuation chair.

## Operator Training Course includes:

Your Operator Training course can include up to 4 people at your site to show you how to use your evacuation chair in an emergency.

- All delegates receive training material
  - Supervised operation on your stairs
- Certification in the safe use of the chair

**Estimated course duration : 2 hrs plus**



# 'Train the Trainer'

The purpose of the 'Train the Trainer' course is to enable people to not only be confident in the use of a Safety Chair but be able to cascade their developed knowledge and practical skills to the people around them.

## 'Train the Trainer' Course includes:

Your 'Train the Trainer' course can include up to 4 people at your site to show you how to use your evacuation chair in an emergency.

- All delegates receive training material
- Supervised operation on your stairs
- Explanations of latest legislation, approved codes of practice, reference to key manual handling principles
- Certification in the safe use of the chair
- 'Train the Trainer' certification

**Estimated course duration : 6 hrs plus**



## Evacuation Chair Servicing

Safety Chair provides high quality evacuation chairs which are designed and manufactured with the highest medical standards in mind. As a **Class 1 medical device PUWER regulations** require your evacuation chair is ready to use and remains in the very best condition. After all, you never know when you might really need your evacuation chair.

Servicing is of the utmost importance and should be completed annually. At Safety Chair we offer a fixed cost service programme which guarantees that your evacuation chair is always in good working order.



## Evacuation Site Survey

Having the correct evacuation chairs installed in the right location is critical to a successful evacuation. As part of an evacuation policy/procedure, Safety Chair offer an on-site **Evacuation Site Survey** which will evaluate your fire escape routes to make sure we offer the best coverage.

**Contact us today to book your free appointment.**

## Why do I need an Evacuation Chair?

For a multitude of reasons. For example, the **Regulatory Reform Order (RRO) 2005** highlights the responsibility of evacuation lies with the occupants of the building to be able to evacuate safely. If you have anybody on your premises with mobility impairment or have made your property accessible to those with mobility impairment, you are required to review evacuating those people safely in the event of an emergency.



## What is an evacuation chair?

An evacuation chair helps support the safe evacuation of an individual to a point of ultimate safety. At its core an evacuation chair should help negotiate stairs in an emergency evacuation. It should require minimal personnel to operate. Our Safety Chairs are easy to use and require minimum effort.



## Are evacuation chairs difficult to use?

Not with the right training. It is vital to have competent people capable of using an evacuation chair. Having an evacuation chair is not a tick box exercise, it can prove an essential part of any evacuation plan that needs to negotiate stairs on route to a point of ultimate safety. Depending on the number of people who require training, you may want to consider a train the trainer course so you can certify others.



## Where should it be located?

An evacuation chair should be located in a place of relative safety such as a fire protected stair well. This enables you to deploy an evacuation chair safely and enable safe transfer of the person to the evacuation chair. Space is always a premium so you should not prevent safe evacuation by blocking stair wells or causing a fire door to remain open.

## What chair is right for my situation?

Identify your evacuation routes in the first instance. Do the routes have any particular features that may limit your ability to evacuate using a chair in a timely manner. If you know anybody at your location that will definitely require assistance in the event of an evacuation you will need to formulate a PEEP (Personal Emergency Evacuation Plan). This will help to ensure your plan is both robust and effective whilst taking into consideration the individual and the building surrounding you. Site assessments and demonstrations are a simple way of understanding the feasibility of the equipment you are looking to potentially use.



**Legislation**  
Legislation  
government,  
to regulate, t  
to sanction, t  
separation o

## Evacuation Legislation Are you in compliance?

- Regulatory Reform (Fire Safety) Order 2005
- Health and Safety at Work Act
- Equality Act 2010
- The Medical Device Directive (*Classification 1*)
- Health & Safety Offences Act
- UN Convention on the Rights of Persons with Disabilities (*CRPD*)
- PUWER Provision & Use of Work Equipment Regulations 1998
- BS9999 (*Refer to Annexes G to S*)
- BS8300  
(*Design of Buildings to meet needs of disabled people*)
- Building Regulations Part M



# More Frequently asked questions...

**Q. I HAVE HAD A FIRE RISK ASSESSMENT AND BEEN TOLD TO GET EVACUATION CHAIRS. WHAT DO I DO NEXT?**

**A.** Contact Safety Chair and we will organise a suitable time and date to visit you and complete a free site assessment.

**Q. HOW DO I KNOW IT WORKS?**

**A.** As part of our 'Safety Assessment Process' we look to include the individuals involved in any PEEP or GEEP so you can see the equipment doing what it does best.

**Q. IS AN EVACUATION CHAIR A LEGAL REQUIREMENT?**

**A.** It is a legal requirement for a business and its building to provide adequate evacuation procedures for both mobility impaired and able bodied occupants/staff/visitors in an emergency.

**Q. HOW MUCH WEIGHT CAN IT TAKE?**

**A.** Our EV-4000 model carries up to 200kg. However, if you require the ability to support a larger weight our EV-7000 chair carries up to 230 kg

**Q. I AM WORRIED ABOUT THE WEIGHT DIFFERENCE BETWEEN OPERATOR AND PASSENGER?**

**A.** Confidence is key with this situation. The visual difference between two people can cause you to think you are potentially not capable. The Safety Chair is designed to support 200kg minimising the physical effort needed. Our site assessment 'Safety Audit' will identify training needs on how to use your chair in the most effective manner. This helps us develop the right training course to meet your needs.

**Q. IS THERE ANYTHING OTHER THAN EVACUATION CHAIR TO GET SOMEBODY DOWN THE STAIRS?**

**A.** Evacuation mats are seen as a valid alternative. However, they require a lot more human resource to move a person and trigger many manual handling requirements and subsequent training.

**Q. WHAT IF MY TEAM ARE SCARED TO USE IT?**

**A.** Don't worry. It is understandable that people are hesitant to use evacuation equipment. Our 'Operator Training' and 'Train the Trainer' courses get people familiar with using the chair without putting you at risk.

**Q. IS STAFF TRAINING ESSENTIAL?**

**A.** Our entire range of evacuation chairs come with user guides and all of our chairs have attached pictograms on how to deploy the chair. However, we strongly advise you consider formal training in the near future.

**Q. I AM A TENANT IN A BUILDING AND REQUIRE AUTHORISATION TO INSTALL A CHAIR?**

**A.** Most landlords understand the need for this equipment, and it is super easy to install, with two wall hooks being able to support the weight of the chair. If you feel this is a potential sticking point we would recommend our free standing 'safety mount' which enables you to safely locate chair without having to commit to any works on the building itself.

**Q. WE HAVE MORE THAN ONE EXIT, AND I ONLY HAVE ONE CHAIR?**

**A.** We would urge you to consider covering both exits, however, a risk assessment or PEEP/GEEP should encompass this and the reasoning for its location. This way it enables you to test its validity and whether any revisions need to be considered.

**Q. WE HAVE A POPULATION OF OVER 50 STAFF I AM WORRIED I WILL BLOCK THEIR EVACUATION?**

**A.** An understandable consideration. By placing a chair in a fire protected stair well you will afford yourself the time to deploy your chair and complete any transfers to the Safety Chair. At this point most if not all your existing population should have evacuated giving you safe passage to use your Safety Chair and reach a point of ultimate safety.

**Q. I AM CONFUSED BY THE AMOUNT OF OPTIONS?**

**A.** Safety Chair are committed to 100% satisfaction with all of our customers. Site surveys and demonstrations are a positive way of seeing how the equipment works in your stairwell. Book one with us ... its free!

**Q. THE PERSON WHO MAY NEED THE CHAIR IS NOT CONFIDENT IN THE CHAIR BEING USED WITH THEM. THEY INSIST THEY CAN BUMP THEMSELVES DOWN THE STAIRS.**

**A.** With this situation its always important to include any individual you think may need a Safety Chair. Our team are more than happy to demonstrate on site with the individual involved. It also helps instil confidence for the passenger and operator alike.

**Q. IS THERE EVER A SITUATION WHEN YOU CAN'T USE A SAFETY CHAIR?**

**A.** It is very rare that we will not be able to support the correct solution for you. The Safety Chair range caters for single/dual person operated chairs. Our EV-8000 mechanised chair that makes it even easier to descend or ascend a stair well.

## Our Promise

We strive to make sure that our customers receive the best service possible. That is why we can offer complete peace of mind when purchasing our products.



### PRICE

Our price promise guarantees if you find a similar product or service cheaper elsewhere, we will meet or beat that price.



### INFORMATION

As evacuation experts Safety Chair can help with advice on emergency evacuation plans and legislation.



### QUALITY

You have complete peace of mind knowing our products and services are guaranteed to be of the highest quality. Our products are rigorously tested to exceed all fire, safety and emergency response guidelines.



### FLEXIBILITY

Our products and services are tailored to meet your requirements. If you need us to focus on particular aspects of evacuation procedures please let us know and we will make sure we can help in any way possible.



### RELIABILITY

We always aim to deliver our products on time. Our certified trainers and service engineers will always call ahead to confirm their attendance to make sure any security requirements are met.



### SATISFACTION

Feedback is always important to Safety Chair. In order for us to make a difference be honest and let us know how we can improve so we can exceed your expectations.



### COMPLIANCE

Our Safety Chairs are Class 1 Medical Devices and all of our training and servicing is certificated so that you can provide evidence of any training and servicing that you have taken with Safety Chair.



# SAFETY CHAIR

Experts in safe evacuation

71-75 Shelton Street, London,  
WC2H 9JQ, United Kingdom

+44 (0)203 961 0054

[info@safety-chair.com](mailto:info@safety-chair.com)

[www.safety-chair.com](http://www.safety-chair.com)

