

STI Global Reset



PRODUCT OVERVIEW

The Global ReSet is a unique resettable call point that simulates break glass activation with no broken glass. It is safe to use in areas where glass cannot be used such as food processing plants and common areas. As the units can be simply reset with a key, they provide an ideal solution for locations that suffer from a high number of false activations such as schools, shopping centres and public areas.

HOW IT WORKS

The 'ReSet' uses a simple yet ingenious patented mechanism which consists of a rigid plastic operating element and an over the center spring mechanism. This arrangement provides the feel of real action on operation and simulates break glass activation. Global ReSet is a single-action non-coded initiating station. The signal is activated by pushing the clear operating plate (indicated by the arrows and hand symbol). Once activated, a yellow and black warning flag drops into view. To reset, a special key is inserted into a hole in the bottom and rotated. This eliminates the maintenance requirement to replace broken glass.

KEY FEATURES

General Information

- Resettable call point simulates break glass activation with no broken glass while offering the user the benefits and environmental advantages of a resettable element.
- Three year guarantee against breakage of polycarbonate in normal use (one year on electromechanical and electronic components).

Design

- An indicator drops into view at the top of the window upon activation. The unit simply resets with a key and is immediately ready for re-use.

Construction

- Extremely attractive, high value look and feel: glass appearance maintains operator deterrence, while a visible warning flag confirms activation.

Installation

- Easy installation with no glass elements that could be broken or incorrectly fitted.
- Versatile mounting plate fits U.S., European, double-gang and single-gang mounting box.

Options

- Five colours available.
- Standard or custom activation labelling.

STI Global Reset

Dimensions and Technical Information

FIRE UL MODELS AVAILABLE

Red Global Reset - 'House Flame' logo, with Shield

- GR-RF-01 Flush mount, Series 01 Electrical Arrangement
- GR-RF-02 Flush mount, Series 02 Electrical Arrangement
- GR-RS-01 Surface mount, Series 01 Electrical Arrangement
- GR-RS-02 Surface mount, Series 02 Electrical Arrangement

Red Global Reset - 'House Flame' logo, without Shield

- GR-RF-01-0 Flush mount, Series 01 Electrical Arrangement
- GR-RF-02-0 Flush mount, Series 02 Electrical Arrangement
- GR-RS-01-0 Surface mount, Series 01 Electrical Arrangement
- GR-RS-02-0 Surface mount, Series 02 Electrical Arrangement

For 'FIRE' text label alternative to House Flame Logo:
Add -EN for English, -ES for Spanish, -FR for French

Series 01 = European Conventional PCB with Resistors
Series 02 = Single Pole Changeover

APPROVALS & WARRANTY

Testing

It has been tested and approved or listed by:

- Underwriter Laboratories File No. S2466
- Canadian Underwriter Laboratories Issue File No. S2466



Accessories:

KIT-GLR-BB-*

GLR Backbox kit with 1/2" (12.7mm) NPT Plug.

*Choose colour option: -0 = Red, -1 = Green,

-2 = Yellow, -3 = White, -4 = Blue

KIT-GLR-NPT-*

GLR 1/2" (12.7mm) NPT Plug.

*Choose colour option: -0 = Red, -1 = Green,

-2 = Yellow, -3 = White, -4 = Blue

KIT-GLR-K2

Global ReSet Key 2 Pack

KIT-GLR-K10

Global ReSet Key 10 Pack

KIT-GLR-A

Global ReSet Sounder Add-On Kit (for use with Shield)

KIT-GLR-S-EN

English Global ReSet Shield

KIT-GLR-S-ES

Spanish Global ReSet Shield

KIT-GLR-S-FR

French Global ReSet Shield

BUILD YOUR OWN MODEL

<p>Colour</p> <ul style="list-style-type: none"> 0 - Red (non FIRE models) 1 - Green 2 - Yellow 3 - White 4 - Blue 	
<p>Cover</p> <ul style="list-style-type: none"> 01 - No cover 21 - Shield A1 - Shield with Sounder 	
<p>Message/Text</p> <ul style="list-style-type: none"> AB - ABORT EM - EMERGENCY EX - EMERGENCY EXIT PO - EMERGENCY POWER OFF ES - EMERGENCY STOP EV - EVACUATION XT - EXIT PS - FUEL PUMP SHUT-DOWN HV - HVAC SHUT-DOWN LD - LOCKDOWN PX - PUSH TO EXIT NT - No Text ZA - Custom Label (Default white or black text) RM - Running Man Logo 	
<p>Language</p> <ul style="list-style-type: none"> EN - English ES - Spanish FR - French ZL - Other Language 	

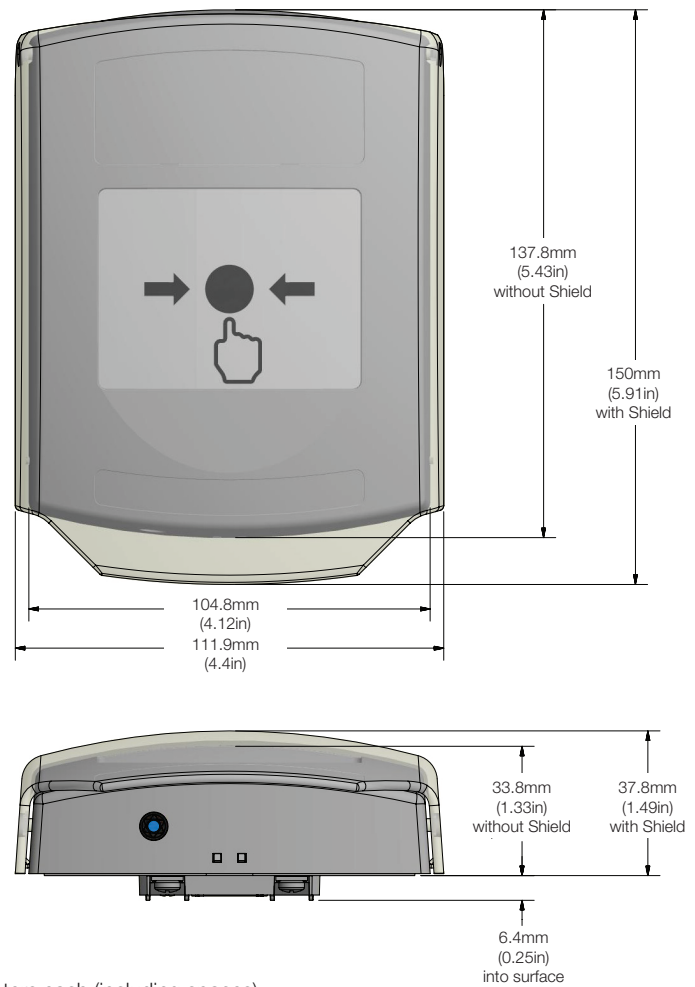

Custom Text Options - 1 Line, 13 Characters Maximum. 2 Lines, 20 Characters each (including spaces)



Safety Technology International

Taylor House
34 Sherwood Road
Bromsgrove
Worcestershire
B60 3DR, England

Tel: +44 (0)1527 520 999
Fax: +44 (0)1527 501 999
info@sti-emea.com
www.sti-emea.com

2306 Airport Road
Waterford, Michigan
48327, USA

Tel: 248-673-9898
Fax: 248-673-1246
Toll-free: 800-888-4784
info@sti-usa.com
www.sti-usa.com